

Subminiatur

Subminiature



Snap-in IP67 Subminiatur

Snap-in IP67 Subminiature

Kabelsteckverbinder

- Snap-in-Verriegelung
- 3 – 8-polig
- Schutzart IP67 ¹⁾
- Lötanschluss
- Am Kabel angespritzte Ausführungen
- Durchmesser 11,5 mm
- Farbige Ausführungen

Flanschsteckverbinder

- Snap-in-Verriegelung
- 3 – 8-polig
- Schutzart IP67 ¹⁾
- Löt-/Tauchlötanschluss
- Durchmesser 11,5 mm
- Farbige Ausführungen

Cable Connectors

- Snap-in locking system
- 3 – 8 contacts
- Degree of protection IP67 ¹⁾
- Solder termination
- Moulded versions
- Diameter 11.5 mm
- Coloured versions

Panel Mount Connectors

- Snap-in locking system
- 3 – 8 contacts
- Degree of protection IP67 ¹⁾
- Solder/dip solder termination
- Diameter 11.5 mm
- Coloured versions

¹⁾Erläuterung der Schutzarten siehe technische Informationen./ ¹⁾Explanation of protection standards see technical information.

Kabelstecker
Male cable connector

Abbildung / Figure



Kabelstecker
Male cable connector



Maßzeichnung / Drawing

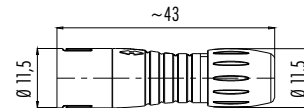
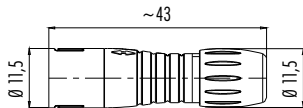

Bestell-Daten / Order Data

| Polzahl Contacts | Kabeldurchlass max. Max. cable outlet | Bestell-Nr. Ordering-No. |
|---------------------|--|-----------------------------|
| 3 | 3,5-5 mm | 99 9205 00 03 |
| 4 | 3,5-5 mm | 99 9209 00 04 |
| 5 | 3,5-5 mm | 99 9213 00 05 |
| 8 | 3,5-5 mm | 99 9225 00 08 |

| Polzahl Contacts | Kabeldurchlass max. Max. cable outlet | Rot Red | Blau Blue | Grün Green |
|---------------------|--|----------------|----------------|----------------|
| 3 | 3,5-5 mm | 99 9205 050 03 | 99 9205 060 03 | 99 9205 070 03 |
| 4 | 3,5-5 mm | 99 9209 050 04 | 99 9209 060 04 | 99 9209 070 04 |
| 5 | 3,5-5 mm | 99 9213 050 05 | 99 9213 060 05 | 99 9213 070 05 |
| 8 | 3,5-5 mm | 99 9225 050 08 | 99 9225 060 08 | 99 9225 070 08 |

Technische Daten / Specifications

| Polzahl | 3 | 4 | 5 | 8 | Number of contacts |
|-----------------------------|---|-------|-----|-------|--------------------------|
| Steckverbinder Verriegelung | schnapp/snap-in | | | | Connector locking system |
| Anschlussart | löten/solder | | | | Termination |
| Anschlussquerschnitt | max. 0,25 mm ² (max. AWG 24) | | | | Wire gauge |
| Kabeldurchlass | 3,5-5 mm | | | | Cable outlet |
| Schutzart | IP67 | | | | Degree of protection |
| Mechanische Lebensdauer | > 500 Steckzyklen/> 500 mating cycles | | | | Mechanical operation |
| Obere Grenztemperatur | + 85 °C | | | | Upper temperature |
| Untere Grenztemperatur | - 25 °C | | | | Lower temperature |
| Bemessungsspannung | 125 V | | | 63 V | Rated voltage |
| Bemessungs-Stoßspannung | 1500 V | | | 800 V | Rated impulse voltage |
| Verschmutzungsgrad | 2 | | | | Pollution degree |
| Überspannungskategorie | II | | | | Overvoltage categorie |
| Isolierstoffgruppe | II | | | | Material group |
| Bemessungsstrom (40°C) | 3 A | 2,5 A | 2 A | 1 A | Rated current (40 °C) |
| Durchgangswiderstand | ≤ 3 mΩ | | | | Contact resistance |
| Material Kontakt | CuZn (Messing/brass) | | | | Material of contact |
| Kontaktoberfläche | Au (Gold/gold) | | | | Contact plating |
| Material Kontaktkörper | PA | | | | Material of contact body |
| Material Gehäuse | PA | | | | Material of housing |

Kabeldose
Female cable connector

Abbildung / Figure



Kabeldose
Female cable connector



Maßzeichnung / Drawing

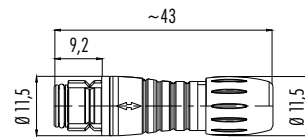
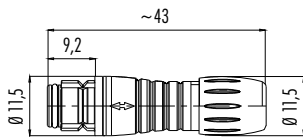

Bestell-Daten / Order Data

| Polzahl Contacts | Kabeldurchlass max. Max. cable outlet | Bestell-Nr. Ordering-No. |
|---------------------|--|-----------------------------|
| 3 | 3,5-5 mm | 99 9206 00 03 |
| 4 | 3,5-5 mm | 99 9210 00 04 |
| 5 | 3,5-5 mm | 99 9214 00 05 |
| 8 | 3,5-5 mm | 99 9226 00 08 |

| Polzahl Contacts | Kabeldurchlass max. Max. cable outlet | Rot Red | Blau Blue | Grün Green |
|---------------------|--|----------------|----------------|----------------|
| 3 | 3,5-5 mm | 99 9206 050 03 | 99 9206 060 03 | 99 9206 070 03 |
| 4 | 3,5-5 mm | 99 9210 050 04 | 99 9210 060 04 | 99 9210 070 04 |
| 5 | 3,5-5 mm | 99 9214 050 05 | 99 9214 060 05 | 99 9214 070 05 |
| 8 | 3,5-5 mm | 99 9226 050 08 | 99 9226 060 08 | 99 9226 070 08 |

Technische Daten / Specifications

| Polzahl | 3 | 4 | 5 | 8 | Number of contacts |
|-----------------------------|---|-------|-----|-------|--------------------------|
| Steckverbinder Verriegelung | schnapp/snap-in | | | | Connector locking system |
| Anschlussart | löten/solder | | | | Termination |
| Anschlussquerschnitt | max. 0,25 mm ² (max. AWG 24) | | | | Wire gauge |
| Kabeldurchlass | 3,5-5 mm | | | | Cable outlet |
| Schutzart | IP67 | | | | Degree of protection |
| Mechanische Lebensdauer | > 500 Steckzyklen/> 500 mating cycles | | | | Mechanical operation |
| Obere Grenztemperatur | + 85 °C | | | | Upper temperature |
| Untere Grenztemperatur | - 25 °C | | | | Lower temperature |
| Bemessungsspannung | 125 V | | | 63 V | Rated voltage |
| Bemessungs-Stoßspannung | 1500 V | | | 800 V | Rated impulse voltage |
| Verschmutzungsgrad | 2 | | | | Pollution degree |
| Überspannungskategorie | II | | | | Overvoltage categorie |
| Isolierstoffgruppe | II | | | | Material group |
| Bemessungsstrom (40°C) | 3 A | 2,5 A | 2 A | 1 A | Rated current (40 °C) |
| Durchgangswiderstand | ≤ 3 mΩ | | | | Contact resistance |
| Material Kontakt | CuSn (Bronze/bronze) | | | | Material of contact |
| Kontaktoberfläche | Au (Gold/gold) | | | | Contact plating |
| Material Kontaktkörper | PA | | | | Material of contact body |
| Material Gehäuse | PA | | | | Material of housing |

Einzelteildarstellung
Component part drawing

Kabelsteckverbinder
Cable connectors

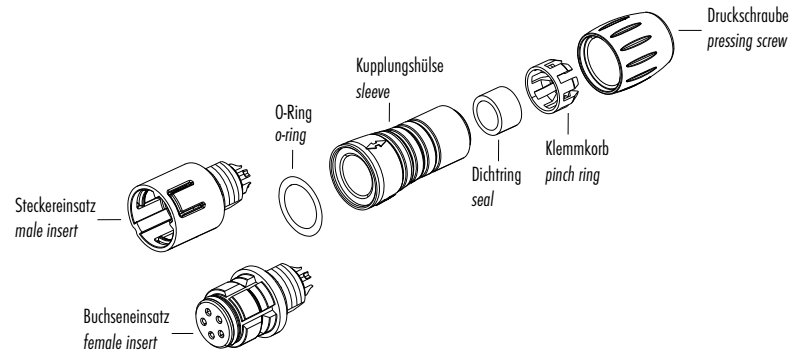



Kabelstecker
Male cable connector

Abbildung / Figure



Kabeldose
Female cable connector



Maßzeichnung / Drawing

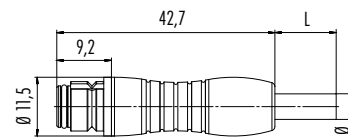
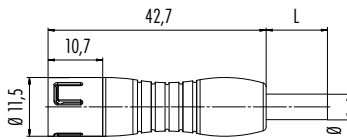

Bestell-Daten / Order Data

| Polzahl Contacts | Kabellänge Cable length | Bestell-Nr. Ordering-No. |
|---------------------|----------------------------|-----------------------------|
| 3 | 2 m | 79 9237 020 03 |
| 4 | 2 m | 79 9241 020 04 |
| 5 | 2 m | 79 9245 020 05 |
| 8 | 2 m | 79 9257 020 08 |

| Polzahl Contacts | Kabellänge Cable length | Bestell-Nr. Ordering-No. |
|---------------------|----------------------------|-----------------------------|
| 3 | 2 m | 79 9238 020 03 |
| 4 | 2 m | 79 9242 020 04 |
| 5 | 2 m | 79 9246 020 05 |
| 8 | 2 m | 79 9258 020 08 |

Technische Daten / Specifications

| Polzahl | 3 | 4 | 5 | 8 | Number of contacts |
|-----------------------------|--|-------|-----|-------|--------------------------|
| Steckverbinder Verriegelung | schnapp/snap-in | | | | Connector locking system |
| Anschlussart | am Kabel angespritzt/moulded | | | | Termination |
| Anschlussquerschnitt | 0,25 mm ² (AWG 24) | | | | Wire gauge |
| Kabeldurchlass | — | | | | Cable outlet |
| Schutzart | IP67 | | | | Degree of protection |
| Mechanische Lebensdauer | > 500 Steckzyklen/> 500 mating cycles | | | | Mechanical operation |
| Obere Grenztemperatur | + 70 °C | | | | Upper temperature |
| Untere Grenztemperatur | - 25 °C | | | | Lower temperature |
| Bemessungsspannung | 125 V | | | 63 V | Rated voltage |
| Bemessungs-Stoßspannung | 1500 V | | | 800 V | Rated impulse voltage |
| Verschmutzungsgrad | 2 | | | | Pollution degree |
| Überspannungskategorie | II | | | | Overvoltage categorie |
| Isolierstoffgruppe | II | | | | Material group |
| Bemessungsstrom (40 °C) | 3 A | 2,5 A | 2 A | 1 A | Rated current (40 °C) |
| Durchgangswiderstand | ≤ 3 mΩ | | | | Contact resistance |
| Material Kontakt | Stift/pin CuZn (Messing/brass), Buchse/socket CuSn (Bronze/bronze) | | | | Material of contact |
| Kontaktoberfläche | Au (Gold/gold) | | | | Contact plating |
| Material Kontaktkörper | PA | | | | Material of contact body |
| Material Gehäuse | PUR | | | | Material of housing |

Technische Daten Kabel
Specifications of cable

| Polzahl | 3 | 4 | 5 | 8 | Number of contacts |
|---|-----------------------------------|-----------------------------------|-----------------------------------|-----------------------------------|--|
| Querschnitt mm ² ¹⁾ | 3 x 0,25 mm ² (AWG 24) | 4 x 0,25 mm ² (AWG 24) | 5 x 0,25 mm ² (AWG 24) | 8 x 0,25 mm ² (AWG 24) | Wire gauge mm ² ¹⁾ |
| Material Mantel | PVC | PUR | | | Material jacket |
| Isolation Litze | PVC | | | | Insulation wire |
| Litzenaufbau (mm) | 32 x 0,1 | | | | Design of wire (mm) |
| Kabelmantel Ø (mm) | 4,5 ^{+0,2} | | 5 ^{+0,2} | 5,7 ^{+0,2} | Cable jacket Ø (mm) |
| Leiterwiderstand | 72 Ω/Km (20 °C) | 80 Ω/Km (20 °C) | 78 Ω/Km (20 °C) | 80 Ω/Km (20 °C) | Resistance of wire |
| Temperaturbereich (Kabel bewegt) | - 20 °C /+ 80 °C | - 5 °C /+ 80 °C | - 5 °C /+ 70 °C | | Temperature range (cable in move) |
| Temperaturbereich (Kabel fest) | - 40 °C /+ 80 °C | - 25 °C /+ 80 °C | - 25 °C /+ 70 °C | | Temperature range (cable not in move) |
| Biegeradius (Kabel bewegt) | 45 mm | | 50 mm | 68 mm | Bending radius (cable in move) |
| Biegeradius (Kabel fest) | 22 mm | | 25 mm | 28 mm | Bending radius (cable not in move) |
| Zulassung | — | | | | Approval |

¹⁾ Vergleichbare AWG Leiter siehe technische Informationen./ ¹⁾ Comparable AWG conductors see technical information.

Flanschstecker
Male panel mount connector

Abbildung / Figure



Flanschstecker
Male panel mount connector



Maßzeichnung / Drawing

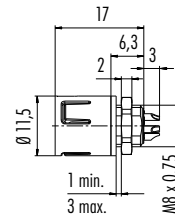
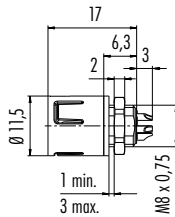

Bestell-Daten / Order Data

| Polzahl Contacts | Bestell-Nr. Ordering-No. |
|---------------------|-----------------------------|
| 3 | 99 9207 00 03 |
| 4 | 99 9211 00 04 |
| 5 | 99 9215 00 05 |
| 8 | 99 9227 00 08 |

| Polzahl Contacts | Rot Red | Blau Blue | Grün Green |
|---------------------|----------------|----------------|----------------|
| 3 | 99 9207 050 03 | 99 9207 060 03 | 99 9207 070 03 |
| 4 | 99 9211 050 04 | 99 9211 060 04 | 99 9211 070 04 |
| 5 | 99 9215 050 05 | 99 9215 060 05 | 99 9215 070 05 |
| 8 | 99 9227 050 08 | 99 9227 060 08 | 99 9227 070 08 |

Technische Daten / Specifications

| Polzahl | 3 | 4 | 5 | 8 | Number of contacts |
|-----------------------------|---|-------|-----|-------|--------------------------|
| Steckverbinder Verriegelung | schnapp/snap-in | | | | Connector locking system |
| Anschlussart | löten/solder | | | | Termination |
| Anschlussquerschnitt | max. 0,25 mm ² (max. AWG 24) | | | | Wire gauge |
| Kabeldurchlass | — | | | | Cable outlet |
| Schutzart | IP67 | | | | Degree of protection |
| Mechanische Lebensdauer | > 500 Steckzyklen/> 500 mating cycles | | | | Mechanical operation |
| Obere Grenztemperatur | + 85 °C | | | | Upper temperature |
| Untere Grenztemperatur | - 25 °C | | | | Lower temperature |
| Bemessungsspannung | 125 V | | | 63 V | Rated voltage |
| Bemessungs-Stoßspannung | 1500 V | | | 800 V | Rated impulse voltage |
| Verschmutzungsgrad | 2 | | | | Pollution degree |
| Überspannungskategorie | II | | | | Overvoltage categorie |
| Isolierstoffgruppe | II | | | | Material group |
| Bemessungsstrom (40 °C) | 3 A | 2,5 A | 2 A | 1 A | Rated current (40 °C) |
| Durchgangswiderstand | ≤ 3 mΩ | | | | Contact resistance |
| Material Kontakt | CuZn (Messing/brass) | | | | Material of contact |
| Kontaktoberfläche | Au (Gold/gold) | | | | Contact plating |
| Material Kontaktkörper | PA | | | | Material of contact body |
| Material Gehäuse | PA | | | | Material of housing |

Flanschstecker, tauchlöten
Male panel mount connector, dip solder

Abbildung / Figure



Maßzeichnung / Drawing

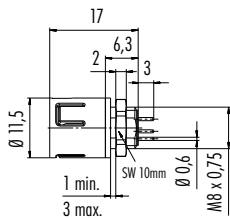

Bestell-Daten / Order Data

| Polzahl Contacts | Bestell-Nr. Ordering-No. |
|---------------------|-----------------------------|
| 3 | 99 9207 090 03 |
| 4 | 99 9211 090 04 |
| 5 | 99 9215 090 05 |
| 8 | 99 9227 090 08 |

Technische Daten / Specifications

| Polzahl | 3 | 4 | 5 | 8 | Number of contacts |
|-----------------------------|---------------------------------------|-------|-----|-------|--------------------------|
| Steckverbinder Verriegelung | schnapp/snap-in | | | | Connector locking system |
| Anschlussart | tauchlöten/dip solder | | | | Termination |
| Anschlussquerschnitt | — | | | | Wire gauge |
| Kabeldurchlass | — | | | | Cable outlet |
| Schutzart | IP67 | | | | Degree of protection |
| Mechanische Lebensdauer | > 500 Steckzyklen/> 500 mating cycles | | | | Mechanical operation |
| Obere Grenztemperatur | + 85 °C | | | | Upper temperature |
| Untere Grenztemperatur | - 25 °C | | | | Lower temperature |
| Bemessungsspannung | 125 V | | | 63 V | Rated voltage |
| Bemessungs-Stoßspannung | 1500 V | | | 800 V | Rated impulse voltage |
| Verschmutzungsgrad | 2 | | | | Pollution degree |
| Überspannungskategorie | II | | | | Overvoltage categorie |
| Isolierstoffgruppe | II | | | | Material group |
| Bemessungsstrom (40°C) | 3 A | 2,5 A | 2 A | 1 A | Rated current (40 °C) |
| Durchgangswiderstand | ≤ 3 mΩ | | | | Contact resistance |
| Material Kontakt | CuZn (Messing/brass) | | | | Material of contact |
| Kontaktoberfläche | Au (Gold/gold) | | | | Contact plating |
| Material Kontaktkörper | PA | | | | Material of contact body |
| Material Gehäuse | PA | | | | Material of housing |

Flanschdose
Female panel mount connector

Abbildung / Figure



Flanschdose
Female panel mount connector



Maßzeichnung / Drawing

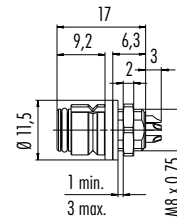
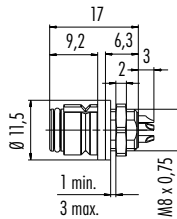

Bestell-Daten / Order Data

| Polzahl Contacts | Bestell-Nr. Ordering-No. |
|---------------------|-----------------------------|
| 3 | 99 9208 00 03 |
| 4 | 99 9212 00 04 |
| 5 | 99 9216 00 05 |
| 8 | 99 9228 00 08 |

| Polzahl Contacts | Rot Red | Blau Blue | Grün Green |
|---------------------|----------------|----------------|----------------|
| 3 | 99 9208 050 03 | 99 9208 060 03 | 99 9208 070 03 |
| 4 | 99 9212 050 04 | 99 9212 060 04 | 99 9212 070 04 |
| 5 | 99 9216 050 05 | 99 9216 060 05 | 99 9216 070 05 |
| 8 | 99 9228 050 08 | 99 9228 060 08 | 99 9228 070 08 |

Technische Daten / Specifications

| Polzahl | 3 | 4 | 5 | 8 | Number of contacts |
|-----------------------------|---|-------|-----|-------|--------------------------|
| Steckverbinder Verriegelung | schnapp/snap-in | | | | Connector locking system |
| Anschlussart | löten/solder | | | | Termination |
| Anschlussquerschnitt | max. 0,25 mm ² (max. AWG 24) | | | | Wire gauge |
| Kabeldurchlass | — | | | | Cable outlet |
| Schutzart | IP67 | | | | Degree of protection |
| Mechanische Lebensdauer | > 500 Steckzyklen/> 500 mating cycles | | | | Mechanical operation |
| Obere Grenztemperatur | + 85 °C | | | | Upper temperature |
| Untere Grenztemperatur | - 25 °C | | | | Lower temperature |
| Bemessungsspannung | 125 V | | | 63 V | Rated voltage |
| Bemessungs-Stoßspannung | 1500 V | | | 800 V | Rated impulse voltage |
| Verschmutzungsgrad | 2 | | | | Pollution degree |
| Überspannungskategorie | II | | | | Overvoltage categorie |
| Isolierstoffgruppe | II | | | | Material group |
| Bemessungsstrom (40 °C) | 3 A | 2,5 A | 2 A | 1 A | Rated current (40 °C) |
| Durchgangswiderstand | ≤ 3 mΩ | | | | Contact resistance |
| Material Kontakt | CuSn (Bronze/bronze) | | | | Material of contact |
| Kontaktoberfläche | Au (Gold/gold) | | | | Contact plating |
| Material Kontaktkörper | PA | | | | Material of contact body |
| Material Gehäuse | PA | | | | Material of housing |

Flanschdose, tauchlöten
Female panel mount connector, dip solder

Abbildung / Figure



Maßzeichnung / Drawing

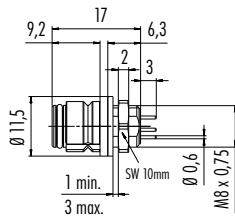

Bestell-Daten / Order Data

| Polzahl Contacts | Bestell-Nr. Ordering-No. |
|---------------------|-----------------------------|
| 3 | 99 9208 090 03 |
| 4 | 99 9212 090 04 |
| 5 | 99 9216 090 05 |
| 8 | 99 9228 090 08 |

Technische Daten / Specifications

| Polzahl | 3 | 4 | 5 | 8 | Number of contacts |
|-----------------------------|---------------------------------------|-------|-----|-------|--------------------------|
| Steckverbinder Verriegelung | schnapp/snap-in | | | | Connector locking system |
| Anschlussart | tauchlöten/dip solder | | | | Termination |
| Anschlussquerschnitt | — | | | | Wire gauge |
| Kabeldurchlass | — | | | | Cable outlet |
| Schutzart | IP67 | | | | Degree of protection |
| Mechanische Lebensdauer | > 500 Steckzyklen/> 500 mating cycles | | | | Mechanical operation |
| Obere Grenztemperatur | + 85 °C | | | | Upper temperature |
| Untere Grenztemperatur | - 25 °C | | | | Lower temperature |
| Bemessungsspannung | 125 V | | | 63 V | Rated voltage |
| Bemessungs-Stoßspannung | 1500 V | | | 800 V | Rated impulse voltage |
| Verschmutzungsgrad | 2 | | | | Pollution degree |
| Überspannungskategorie | II | | | | Overvoltage categorie |
| Isolierstoffgruppe | II | | | | Material group |
| Bemessungsstrom (40°C) | 3 A | 2,5 A | 2 A | 1 A | Rated current (40 °C) |
| Durchgangswiderstand | ≤ 3 mΩ | | | | Contact resistance |
| Material Kontakt | CuSn (Bronze/bronze) | | | | Material of contact |
| Kontaktoberfläche | Au (Gold/gold) | | | | Contact plating |
| Material Kontaktkörper | PA | | | | Material of contact body |
| Material Gehäuse | PA | | | | Material of housing |

Adapter für Flanschsteckverbinder
Adapter for panel mount connectors

Abbildung / Figure



Maßzeichnung / Drawing

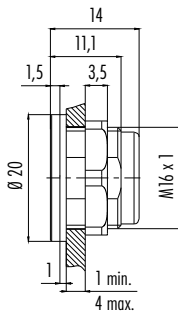

Bestell-Daten / Order Data

Bestell-Nr.
Ordering-No.

08 2636 000 001

Adapter für Flanschsteckverbinder, von vorn verschraubt
Adapter for panel mount connectors, front fastened

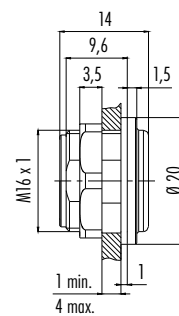

Bestell-Nr.
Ordering-No.

08 2629 000 001

Anwendungsbeispiel für Adapter
Example for use for adapter

Flanschstecker
Male panel mount connector



Flanschstecker mit Adapter
Male panel mount connector with adapter



Flanschdose
Female panel mount connector



Flanschdose mit Adapter, von vorn verschraubbar
Female panel mount connector with adapter, front fastened



Einzelteildarstellung
Component part drawing

Flanschsteckverbinder, löten
Panel mount connectors, solder

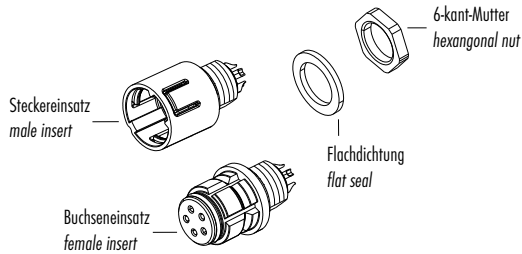

Flanschsteckverbinder, tauchlöten
Panel mount connectors, dip solder

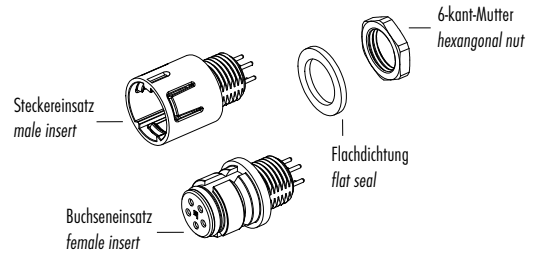

Montage Adapter
Assembly of adapter

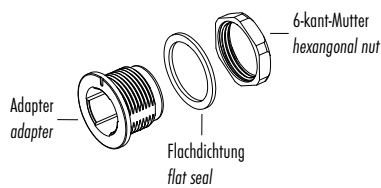

Montage Adapter, von vorn verschraubbar
Assembly of adapter, front fastened

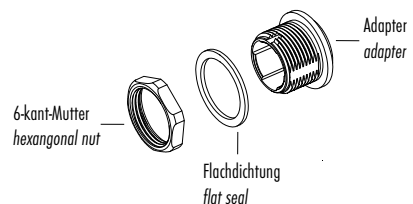

Adapter
Adapter

Die Markierung des Adapters muss mit der Kodiernase des Einsatzes übereinstimmen
The marking of the adapter must be conform with the coding nut of the insert

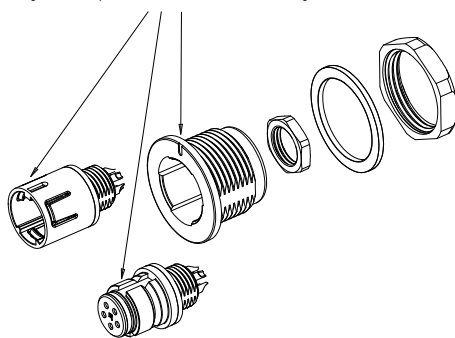

Einsätze müssen separat bestellt werden
Inserts have to be ordered separately

Adapter, von vorn verschraubbar
Adapter, front fastened

Die Markierung des Adapters muss mit der Kodiernase des Einsatzes übereinstimmen
The marking of the adapter must be conform with the coding nut of the insert

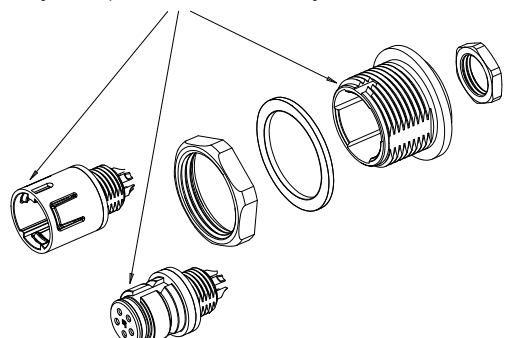

Einsätze müssen separat bestellt werden
Inserts have to be ordered separately

Polbilder
Contact arrangements

Stifteinsatz (Steckseite)
Male insert (mating side)

Buchseinsatz (Steckseite)
Female insert (mating side)

3 pol
3 contacts

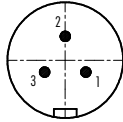

| | X | Y |
|---|-------|-------|
| 1 | 1,82 | -1,05 |
| 2 | 0,00 | 2,10 |
| 3 | -1,82 | -1,05 |

- 1 braun/brown
- 2 blau/blue
- 3 schwarz/black

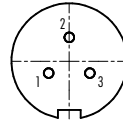

| | X | Y |
|---|-------|-------|
| 1 | -1,82 | -1,05 |
| 2 | 0,00 | 2,10 |
| 3 | 1,82 | -1,05 |

- 1 braun/brown
- 2 blau/blue
- 3 schwarz/black

4 pol
4 contacts

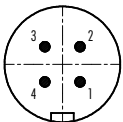

| | X | Y |
|---|-------|-------|
| 1 | 1,55 | -1,55 |
| 2 | 1,55 | 1,55 |
| 3 | -1,55 | 1,55 |
| 4 | -1,55 | -1,55 |

- 1 braun/brown
- 2 weiß/white
- 3 blau/blue
- 4 schwarz/black

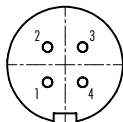

| | X | Y |
|---|-------|-------|
| 1 | -1,55 | -1,55 |
| 2 | -1,55 | 1,55 |
| 3 | 1,55 | 1,55 |
| 4 | 1,55 | -1,55 |

- 1 braun/brown
- 2 weiß/white
- 3 blau/blue
- 4 schwarz/black

5 pol
5 contacts

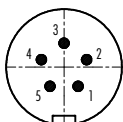

| | X | Y |
|---|-------|-------|
| 1 | 1,23 | -1,70 |
| 2 | 2,00 | 0,65 |
| 3 | 0,00 | 2,10 |
| 4 | -2,00 | 0,65 |
| 5 | -1,23 | -1,70 |

- 1 braun/brown
- 2 weiß/white
- 3 blau/blue
- 4 schwarz/black
- 5 grau/grey

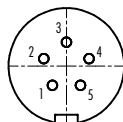

| | X | Y |
|---|-------|-------|
| 1 | -1,23 | -1,70 |
| 2 | -2,00 | 0,65 |
| 3 | 0,00 | 2,10 |
| 4 | 2,00 | 0,65 |
| 5 | 1,23 | -1,70 |

- 1 braun/brown
- 2 weiß/white
- 3 blau/blue
- 4 schwarz/black
- 5 grau/grey

8 pol
8 contacts

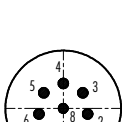

| | X | Y |
|---|-------|-------|
| 1 | 0,96 | -1,98 |
| 2 | 2,15 | -0,49 |
| 3 | 1,72 | 1,37 |
| 4 | 0,00 | 2,20 |
| 5 | -1,72 | 1,37 |
| 6 | -2,15 | -0,49 |
| 7 | -0,96 | -1,98 |
| 8 | 0,00 | 0,00 |

- 1 weiß/white
- 2 braun/brown
- 3 grün/green
- 4 gelb/yellow
- 5 grau/grey
- 6 rosa/pink
- 7 blau/blue
- 8 rot/red

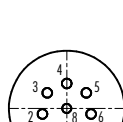

| | X | Y |
|---|-------|-------|
| 1 | -0,96 | -1,98 |
| 2 | -2,15 | -0,49 |
| 3 | -1,72 | 1,37 |
| 4 | 0,00 | 2,20 |
| 5 | 1,72 | 1,37 |
| 6 | 2,15 | -0,49 |
| 7 | 0,96 | -1,98 |
| 8 | 0,00 | 0,00 |

- 1 weiß/white
- 2 braun/brown
- 3 grün/green
- 4 gelb/yellow
- 5 grau/grey
- 6 rosa/pink
- 7 blau/blue
- 8 rot/red

Montageausschnitt
Panel cut out

Flanschsteckverbinder
Socket connectors

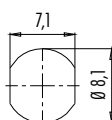

Adapter
Adapter

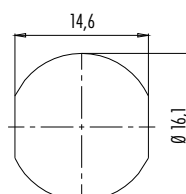

Schutzkappe für Kabelstecker
Protection cap for male cable connector

Abbildung / Figure



Maßzeichnung / Drawing

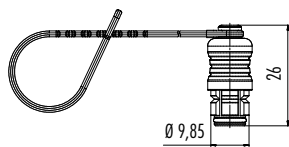

Bestell-Daten / Order Data

Bestell-Nr.
Ordering-No.

08 2813 000 000

Schutzkappe für Kabeldose
Protection cap for female cable connector

Abbildung / Figure



Maßzeichnung / Drawing

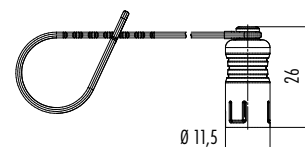

Bestell-Daten / Order Data

Bestell-Nr.
Ordering-No.

08 2823 000 000

Schutzkappe für Flanschstecker
Protection cap for male panel mount connector

Abbildung / Figure



Maßzeichnung / Drawing

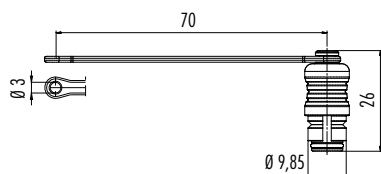

Bestell-Daten / Order Data

Bestell-Nr.
Ordering-No.

08 2839 000 000

Schutzkappe für Flanschdose
Protection cap for female panel mount connector

Abbildung / Figure



Maßzeichnung / Drawing

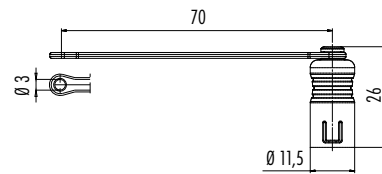

Bestell-Daten / Order Data

Bestell-Nr.
Ordering-No.

08 2831 000 000